

LED Driver dimmable by phasecut dimmer

Driver Phasecut 150W/24V IP20 Radium

Radium

Product Datasheet Date: 10.09.2021

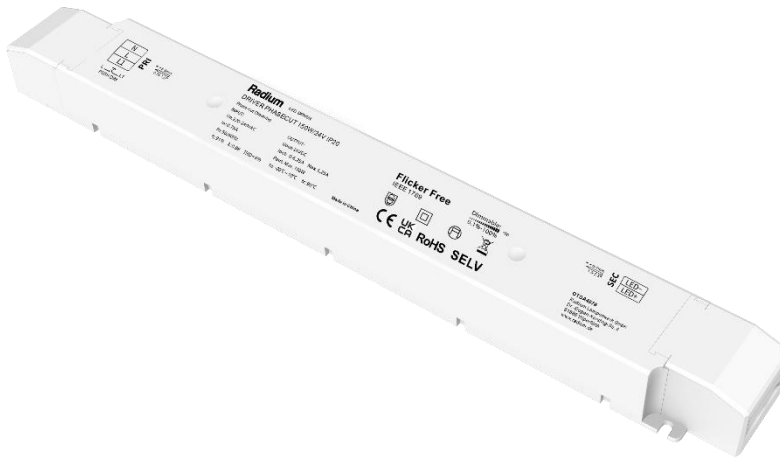

Please, dump as special waste, no ordinary household waste!

General Data

Article No.	OTDA4078
Code	DRIVER PHASECUT 150W/24V IP20 RADIUM
Product EAN	4003556011052
Customs tariff no.	85044082
Box quantity (pcs.)	20
EAN Box	4003556411050
Gross weight of box in kg	9.4
Length of box in m	0.370
Width of box in m	0.340
Height of box in m	0.093
ETIM class	EC002710
ETIM class name	LED driver
Weight	430 g
Product status	Active

Electric Parameters

Output power	0-150 W
Effective input voltage	230 V

Electric Parameters

Output Voltage	24 V
Inrush current	45 A
Input current	0.75 A
Current out	6.25 A
Supply frequency	50 / 60 Hz
Dimmable	Yes

Light Application Parameters

Dimming range	0 - 100 %
---------------	-----------

Service Life

Service life	50000 h
--------------	---------

Specification

Length	352 mm
Height	30 mm
Width	43 mm
Model	Dynamic

Notes on Operation

Degree of protection (IP)	IP20
Mean efficiency	90 %
Protection class	II
Ambient temperatures	-20...+50°C
Tc Temperature max.	90 °C
max. relative air humidity	95 %
Dimming phase cut-off	Yes
Dimming phase cut-on	Yes
Dimming Touch and Dim	Yes
Dimming with push-button	Yes

Notes

One channel constant voltage supply 24V, dimmable by leading or trailing edge phasecut dimmer, for indoor applications

Please, refer to www.radium.de/recycling for notes on disposal of burned-out lamps as well as lamp breakage.
The "lifespan L70" described for LED lamps indicates the number of hours when the luminous flux has decreased to 70% of its initial value.
The optional field 'info about service life' contains the frame conditions according to standards based on which the specific service life has been determined. So, for example, "12B50, 50Hz" means that the mean service life (B50) has been determined with a 12h switching cycle at mains (frequency 50Hz), "3B50, HF" is based on a 3h switching cycle at electronic control gear (high frequency).

LED Driver dimmable by phasecut dimmer

Driver Phasecut 150W/24V IP20 Radium

Radium

Special features

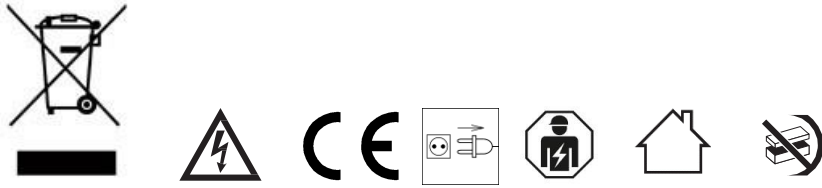

General notes

The technical design data in accordance with DIN and IEC. The producer does not take any responsibility for damage to persons or property in case of unsuitable operation or handling of the product. Operating data and dimensions are valid within the usual tolerances. Related lamp types (different bases, mains voltages) may be available on request. Sale and delivery are effected in accordance with the Radium Terms of Delivery and Payment valid on the day of conclusion of contract. Packing units offer economic advantages to the purchase and logistic department. Please match your quantity volume accordingly. For orders of a minimum quantity (clefts) with a lamp model the amount lower than the volume of each packaging unit, we will invoice 10 % additional charge per lamp type. Technical changes and terms of delivery are reserved. Manipulation of any kind to packaging or product is not permissible as this will violate Radium brand rights. Furthermore, technical properties of the product can change to its disadvantage or even destruction. Therefore, Radium cannot be responsible for consequential damages.

® = Registered trademark

Subject to change without notice. Errors and omissions excepted.

All technical data without guarantee.

All technical data without guarantee.

Dimensions

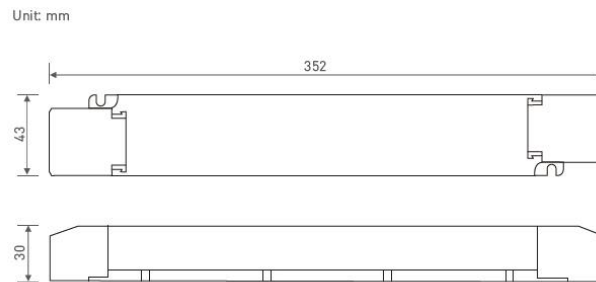

Wiring diagram

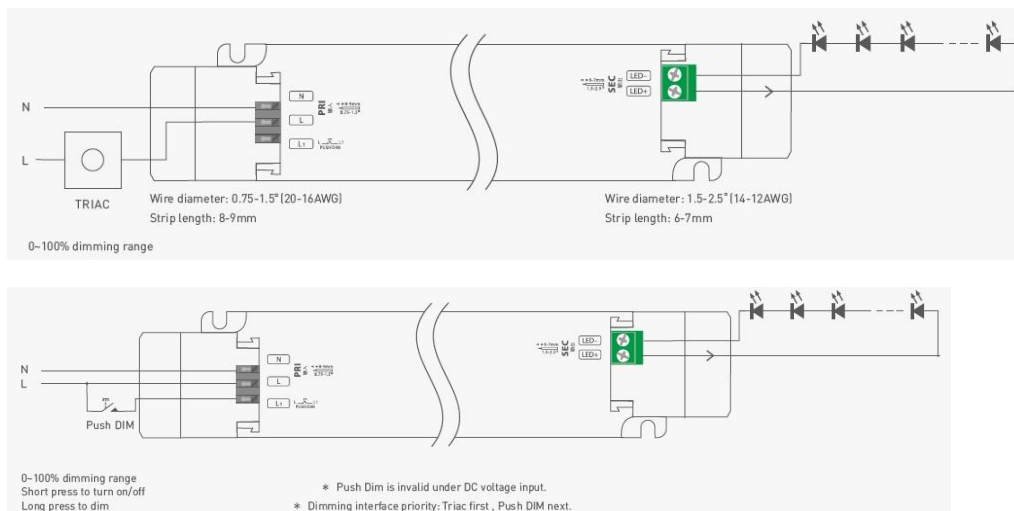

Touch & DIM



Reset switch

- ON/OFF: short press
- Stepless dimming: long press
- With every other long press, the light level goes to the opposite direction
- Dimming memory: Brightness will be the same as previously adjusted when short press on PUSH DIM button.

After Power cut: When Power ON again, brightness will be subjected to the input voltage of drivers.

Protective housing application

Tension Plate



Pry up the protective housing in the side plate position with a tool.



Connect the electric wires with a screwdriver as shown in diagram.

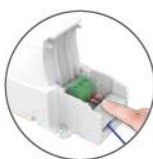

Press down the tension plate to fix the wires and close protective housing.